

## Solenoid Valve 2L Series(High Temperature)

### Symbol



### Order Code

2L	250	-	20	AC110V
Series 2/2 Port Normal Closed	Port Area 170:17mm 200:20mm 250:25mm 350:35mm 400:40mm 500:50mm		Port Size 10:G3/8 15:G1/2 20:G3/4 25:G1 35:G1 1/4 40:G1 1/2 50:G2	Voltage DC12V DC24V AC24V 50/60Hz AC110V 50/60Hz AC220V 50/60Hz AC380V 50/60Hz

### Technical Specification

Model	2L170-10	2L170-15	2L200-20	2L250-25	2L350-35	2L400-40	2L500-50	
Medium	Air/Water/Steam							
Action Mode	Direct-acting Type							
Type	Normal Closed							
Port Diameter(mm <sup>2</sup> )	17	17	20	25	35	40	50	
CV Value	12.6	12.6	17.46	27.27	53.46	69.83	69.83	
Port Size	G3/8	G1/2	G3/4	G1	G1 1/4	G1 1/2	G2	
Working Pressure	0.1~1.5MPa							
Proof Pressure	1.5MPa							
Working Temperature	-5~180°C							
Working Voltage Range	±10%							
Material	Body	Brass						
	Seal	EPDM						

### Dimension

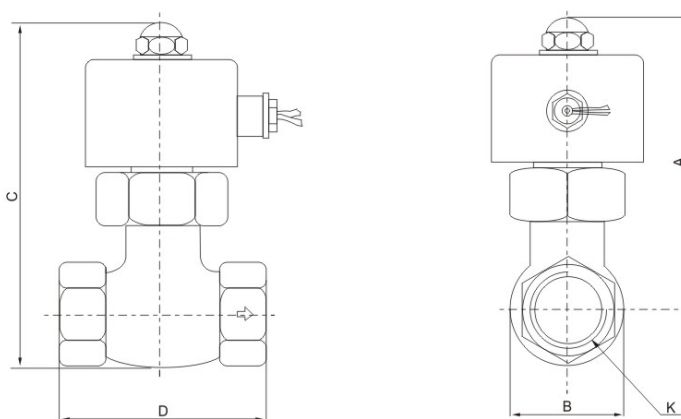

Model	A	B	C	D	K
2L170-10	126	42	146	82	G3/8
2L170-15	126	42	146	82	G1/2
2L200-20	125	42	147	93	G3/4
2L250-25	134	48	156	94	G1
2L350-35	147	74	184	112	G1 1/4
2L400-40	147	74	184	112	G1 1/2
2L500-50	170	90	215	170	G2